



Enduring Decor

FOREST

Aromatherapy Diffuser

User Manual

Model: MGI-201603 "Forest"



Parts Overview

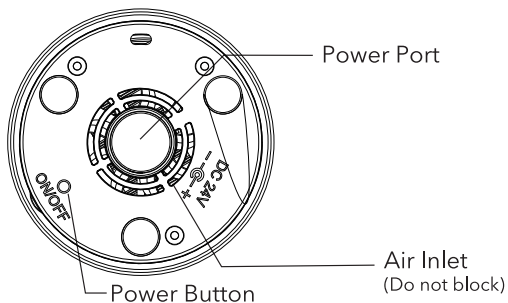
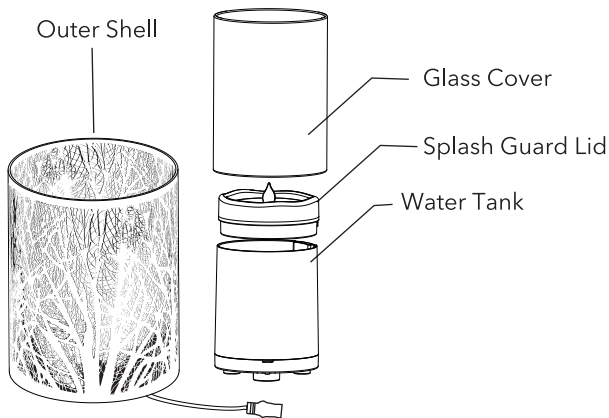

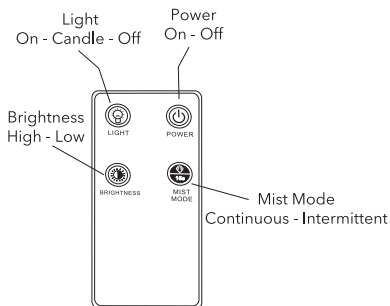
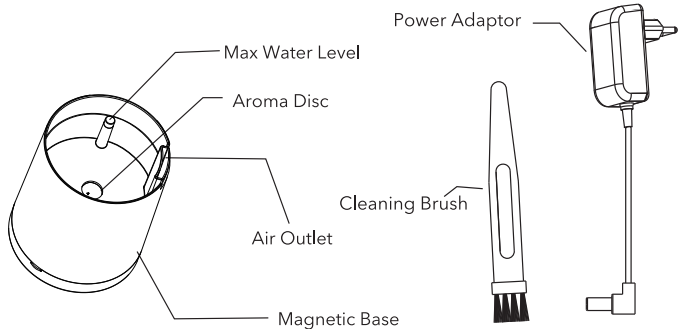

Included in Box

- 1x Aromatherapy Diffuser
- 1x Power Adaptor
- 1x Remote Control
- 1x Cleaning Brush
- 1x User Manual

Product Functions

Bottom Power Button

First Press: The unit will mist continuously for 3 hours

Second Press: The unit will mist intermittently for 6 hours (on/off every 15 seconds)

Third Press: The unit will turn off

Light

The unit contains a warm LED light that provides a gentle glow. Using the remote, you can set the light into bright, dim and flickering candle modes. The product can also be used as a light without using the Aroma function. To do so, press the Light button on the remote when the product is switched off.

Water Shortage Protection

The machine will automatically turn off when the water runs out to protect the unit from damage.

Overheating Protection

The machine will automatically turn off if the unit overheats to protect the unit from damage.

Product Specifications

Water Capacity: 2.6oz (110ml)

Power Adaptor: Input 100-240V A.C. ~50-60Hz 350mA
Output: 24.0V D.C. 500mA

Product Size: 5x6.7in (127x170mm)

Remote Battery: CR2025

Materials: Iron, Glass, PP, ABS

Operating Instructions

1. Carefully remove the diffuser unit from the outer shell and glass cover

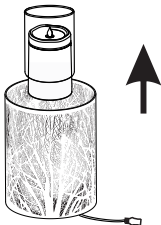

2. Remove the splash guard lid

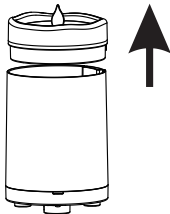

3. Fill the water tank with room temperature water up to the orange fill line and add 2-3 drops of your favorite essential oil

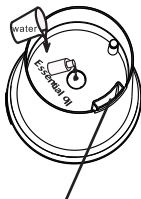

Do not pour any water or oil into the Air Outlet!

4. Replace the lid and carefully place the unit and glass cover into the outer shell

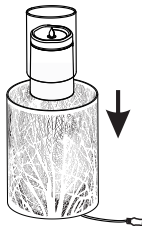

5. Plug the power cord into the device and then into a power outlet.

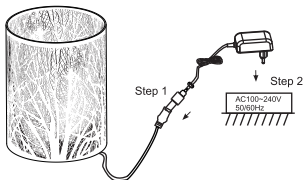

6. Press the Power Button to fill your room with aroma

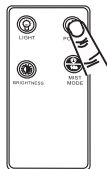

Cleaning Instructions

To avoid oil buildup, you should clean the unit on a regular basis. Some essential oils can be corrosive, so cleaning is very important to the longevity of the product

⚠ Never attempt to clean the unit when it is switched on or plugged in.

To clean the unit, follow the operating instructions steps 1-2 to disassemble the unit. If there is water in the unit, pour it out from the opposite side of the Air Outlet. Use the provided cleaning brush to gently clean the Aroma Disc. If there is a large amount of oil build up, you may use a soft cloth to clean the inside of the water tank. When finished proceed to refill the unit with water and oil and follow steps 4-6 to use the unit again.

Important: When cleaning make sure not to get any water or oil into the air outlet.

Use only the provided cleaning brush or soft cotton swab when cleaning the Aroma Disc. Do not use any harsh or abrasive cleaners to clean the water tank or Aroma Disc.

Important Safety Information

Please read the following safety information before using your product for the first time.

1. The unit should be cleaned after each use. Storing water and oil inside the unit for long periods of time can damage the Aroma Disc.
2. Be careful when adding essential oils to the product. Wipe away any excess oil or spills from the glass or outer shell as they may damage the finish.
3. This product is not a medical device and we make no claims that it treats or cures any illness or disease.
4. Use only 100% pure essential oils in your unit. Oils that contain additives may damage the unit.
5. You may adjust the strength of the aroma by adding more or less than the recommended 2-3 drops. Some oils are more powerful than others.

Warnings

1. Keep the unit away from fire to avoid explosion.
2. Any severe shock to the unit, such as a fall, may damage it.
3. Do not submerge the unit in water, or operate the unit around water such as sinks, swimming pools, and bathtubs.
4. The unit contains no user serviceable parts. To avoid damage do not disassemble the unit. Disassembly of the unit voids the warranty.
5. Do not remove the splash guard lid when the unit is powered on.
6. Never pour water into the air spout as this will damage the electronics and void your warranty.
7. Never insert objects or body parts into the unit when it is plugged in.
8. Always unplug the unit before cleaning.
9. Make sure not to obstruct the air inlet.
10. Keep out of reach of children and pets.
11. Do not move the unit during operation.
12. Only add water and essential oils to the water tank. Other liquids may damage the product.
13. The product is intended for indoor use only.

Troubleshooting

If the machine does not start up properly when powering on, please check the following helpful hints:

Problem	Possible Reasons	Handling
No electricity, not working	Power not connected	Connect the power, press power button
	Power wire broken or faulty adaptor	Please contact Enduring Decor support
Unable to Spray	Water level is too low	Please fill the water
	Water level is too high	Do not exceed the maximum water level
	The Aroma Disc is dirty	Please clean the tank and Aroma Disc
	The top lid is not on correctly	Please replace the top cover
	The bottom air inlet is blocked	Please clean or unobstruct the bottom air inlet
Main body is leaking water	The top lid is not on correctly	Please cover the machine correctly
	The room temperature is too low or too humid	Low temperature and humidity may cause machine malfunction

Additional Info

For additional and updated information about your product, warranty information, as well as any support requests you can visit us on the web at enduringdecor.com.

© 2016 Myers Global Industries LLC.
1964 Utah AVE SE,
Huron, SD 57350



Made in China